

Swivel Hoist Hooks - Latched, C-1014-S, A-1014-0

- Drop Forged Carbon Steel or Alloy and Heat Treated
- Carbon Steel Hooks Are Painted Blue; Alloy Hooks Are Painted Orange
- Design Factor: 5 to 1
- All Hooks Are Drilled for Integrated Latch Kits
- The Latch Is Only Designed to Retain Slings and Rigging Attachments.
The Latch Must Not Support the Load.
- Swivel Hoist Hooks ARE NOT Designed to Swivel Under Load.
- DO NOT EXCEED THE WORKING LOAD LIMIT

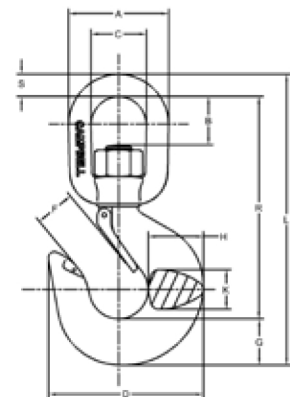

Trade Size	Catalog No.	UPC No. 020418	Material	Finish	Working Load Limit (Short Tons)	Latch Marking	Replacement Latch No.
2	3942205IL	236242	Carbon Steel	Painted Blue	3/4 T	CC-3	T7502101
2	3952215IL	236204	Alloy Steel	Painted Orange	1 T	CC-3	T7502101
3	3942305IL	236792	Carbon Steel	Painted Blue	1 T	CC-3	T7502101
3	3952315IL	236747	Alloy Steel	Painted Orange	1-1/2 T	CC-3	T7502101
4	3942405IL	239243	Carbon Steel	Painted Blue	1-1/2 T	CC-4	7506495
4	3952415IL	239250	Alloy Steel	Painted Orange	2 T	CC-4	7506495
5	3942505IL	238017	Carbon Steel	Painted Blue	2 T	CC-4	7506495
5	3952515IL	238000	Alloy Steel	Painted Orange	3 T	CC-4	7506495
7	3942705IL	240485	Carbon Steel	Painted Blue	3 T	CC-5	7506695
7	3952715IL	240454	Alloy Steel	Painted Orange	4-1/2 T	CC-5	7506695
9	3942905IL	240478	Carbon Steel	Painted Blue	5 T	CC-7	7506895
9	3952915IL	240447	Alloy Steel	Painted Orange	7 T	CC-7	7506895
11	3953115PL	295614	Alloy Steel	Painted Orange	11 T	PL-8	7507095PL
12	3953215IL	240423	Alloy Steel	Painted Orange	15 T	CC-9	7507295
12	3953215PL	295652	Alloy Steel	Painted Orange	15 T	PL-9	7507295PL



FITTINGS

Trade Size	Catalog No.	A Dim.	B Dim.	C Dim.	D Dim.	F Dim.	G Dim.	H Dim.	K Dim.	L Dim.	R Dim.	S Dim.
2	3942205IL	2 in	1 in	1-1/4 in	2-15/16 in	7/8 in	25/32 in	29/32 in	9/16 in	5-5/8 in	4-5/8 in	3/8 in
2	3952215IL	2 in	1 in	1-1/4 in	2-15/16 in	7/8 in	25/32 in	29/32 in	9/16 in	5-5/8 in	4-5/8 in	3/8 in
3	3942305IL	2-1/2 in	1-1/4 in	1-1/2 in	3-1/4 in	7/8 in	27/32 in	31/32 in	5/8 in	6-11/16 in	5-7/16 in	1/2 in
3	3952315IL	2-1/2 in	1-1/4 in	1-1/2 in	3-1/4 in	7/8 in	27/32 in	31/32 in	5/8 in	6-11/16 in	5-7/16 in	1/2 in
4	3942405IL	2-1/2 in	1-1/4 in	1-1/2 in	3-9/16 in	1-1/32 in	1-1/32 in	1-1/8 in	11/16 in	7-5/16 in	5-13/16 in	1/2 in
4	3952415IL	2-1/2 in	1-1/4 in	1-1/2 in	3-9/16 in	1-1/32 in	1-1/32 in	1-1/8 in	11/16 in	7-5/16 in	5-13/16 in	1/2 in
5	3942505IL	3 in	1-5/8 in	1-3/4 in	4 in	1-1/8 in	1-5/32 in	1-5/16 in	13/16 in	8-3/16 in	6-7/16 in	5/8 in
5	3952515IL	3 in	1-5/8 in	1-3/4 in	4 in	1-1/8 in	1-5/32 in	1-5/16 in	13/16 in	8-3/16 in	6-7/16 in	5/8 in
7	3942705IL	3-1/2 in	1-3/4 in	2 in	4-15/16 in	1-15/16 in	1-7/16 in	1-5/8 in	1-1/16 in	9-7/16 in	8 in	3/4 in
7	3952715IL	3-1/2 in	1-3/4 in	2 in	4-15/16 in	1-15/16 in	1-7/16 in	1-5/8 in	1-1/16 in	9-7/16 in	8 in	3/4 in
9	3942905IL	4-1/2 in	2-1/4 in	2-1/2 in	6-15/32 in	1-21/32 in	1-13/16 in	2-1/8 in	1-3/8 in	12-3/8 in	9-5/8 in	1 in
9	3952915IL	4-1/2 in	2-1/4 in	2-1/2 in	6-15/32 in	1-21/32 in	1-13/16 in	2-1/8 in	1-3/8 in	12-3/8 in	9-5/8 in	1 in
11	3953115IL	5-5/8 in	2-27/32 in	3-1/8 in	7-11/32 in	2 in	2-1/4 in	2-5/8 in	1-1/2 in	15 in	11-9/16 in	1-1/4 in
11	3953115PL	5-5/8 in	3-1/8 in	3-1/8 in	7-9/16 in	2-1/32 in	2-9/32 in	2-23/32 in	2 in	15-7/8 in	12-11/32 in	1-1/4 in
12	3943205IL	5-5/8 in	2-3/4 in	3-1/8 in	7-13/16 in	2-1/8 in	2-9/16 in	2-15/16 in	1-13/16 in	16-1/32 in	12-1/4 in	1-1/4 in
12	3953215IL	5-5/8 in	2-3/4 in	3-1/8 in	7-13/16 in	2-1/8 in	2-9/16 in	2-15/16 in	1-13/16 in	16-1/32 in	12-1/4 in	1-1/4 in
12	3953215PL	5-5/8 in	2-3/4 in	3-1/8 in	8-3/4 in	2-9/32 in	2-19/32 in	3-1/8 in	2-1/4 in	16-13/32 in	12-17/32 in	1-1/4 in