

# U S H A P E

## CHANNEL FITTINGS

### 3 HOLE U SUPPORT

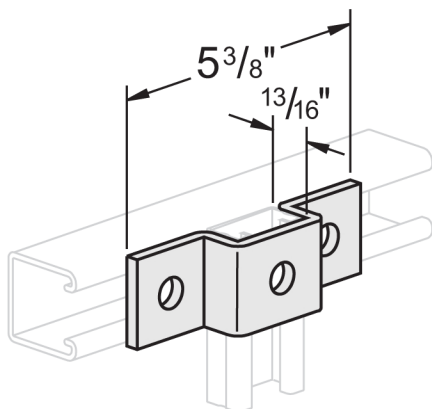

**4696**

25/CTN  
62.0 LBS/100

### 3 HOLE U SUPPORT

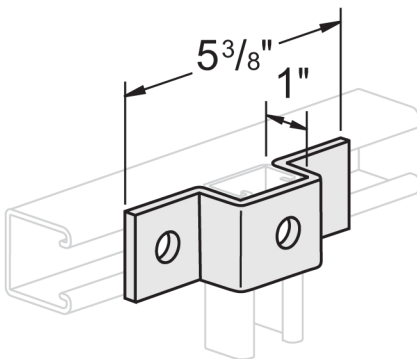

**4697**

25/CTN  
66.0 LBS/100

### 3 HOLE U SUPPORT

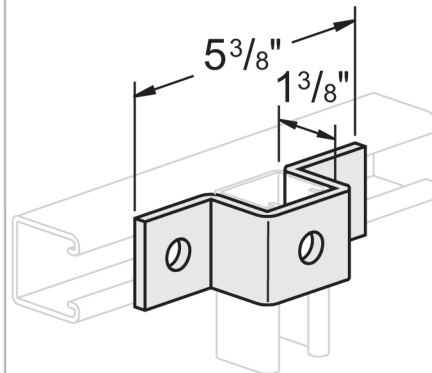

**4698**

25/CTN  
70.0 LBS/100

### 5 HOLE U SUPPORT

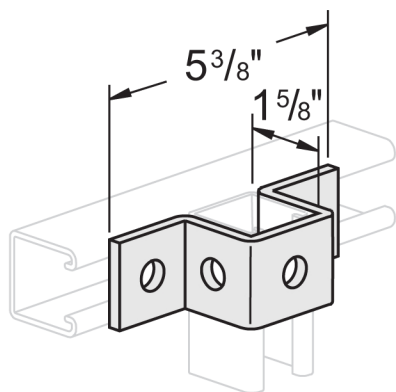

**4699**

15/CTN  
72.0 LBS/100

### 1 HOLE ADJ. U SUPPORT W/ SLOTS

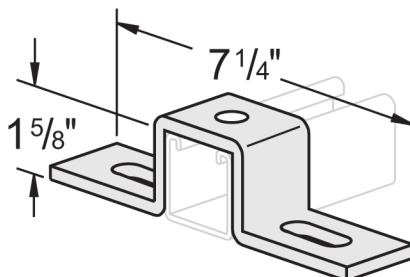

**4700**

10/CTN  
96.0 LBS/100

### 3 HOLE U SUPPORT

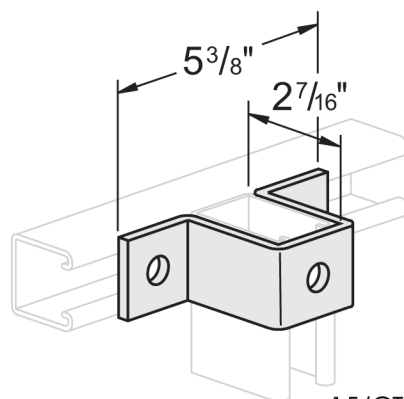

**4702**

15/CTN  
108.0 LBS/100

### 7 HOLE U SUPPORT

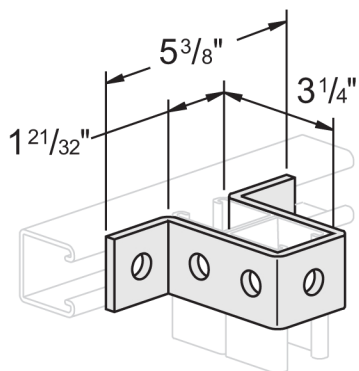

**4703**

25/CTN  
121.0 LBS/100

### 3 HOLE U SUPPORT

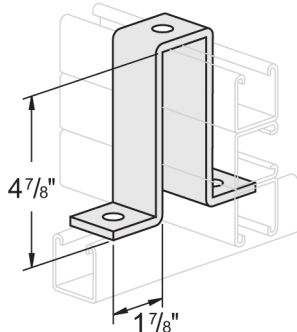

**4704**

10/CTN  
197.0 LBS/100

### 6 HOLE U SUPPORT

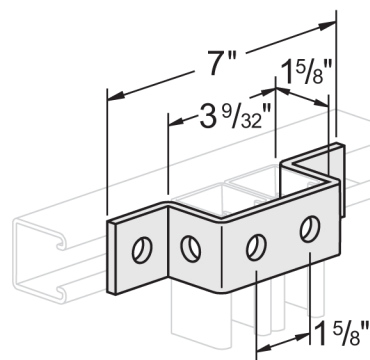

**4701**

10/CTN  
103.0 LBS/100

UNLESS SPECIFIED, MATERIAL IS 1-5/8" WIDE. HOLES ARE 9/16" DIAMETER, 13/16" CENTER TO EDGE, & SPACED 1-7/8" ON CENTER. STANDARD FINISH - EG ALSO AVAILABLE: STAINLESS STEEL & HOT DIPPED GALVANIZED

1.13